

COMP.	DOORS	OPENING DIMENSIONS	VOLUME
L1	ROLL-UP	23.25' W x 48.50' H	18.02 CU. FT.
L2	ROLL-UP	18.25' W x 48.50' H	14.96 CU. FT.
L3	ROLL-UP	24.75' W x 48.50' H	19.75 CU. FT.
L4	ROLL-UP	47.25' W x 48.50' H	28.83 CU. FT.
A1	ROLL-UP	44.50' W x 20.50' H	43.57 CU. FT.

COMP.	DOORS	OPENING DIMENSIONS	VOLUME
R1	ROLL-UP	23.25' W x 35.00' H	17.62 CU. FT.
R2	ROLL-UP	18.25' W x 35.00' H	14.51 CU. FT.
R3	ROLL-UP	18.25' W x 35.00' H	14.51 CU. FT.
R4	ROLL-UP	43.25' W x 35.00' H	27.89 CU. FT.
TOTAL VOLUME			108.75 CU. FT.

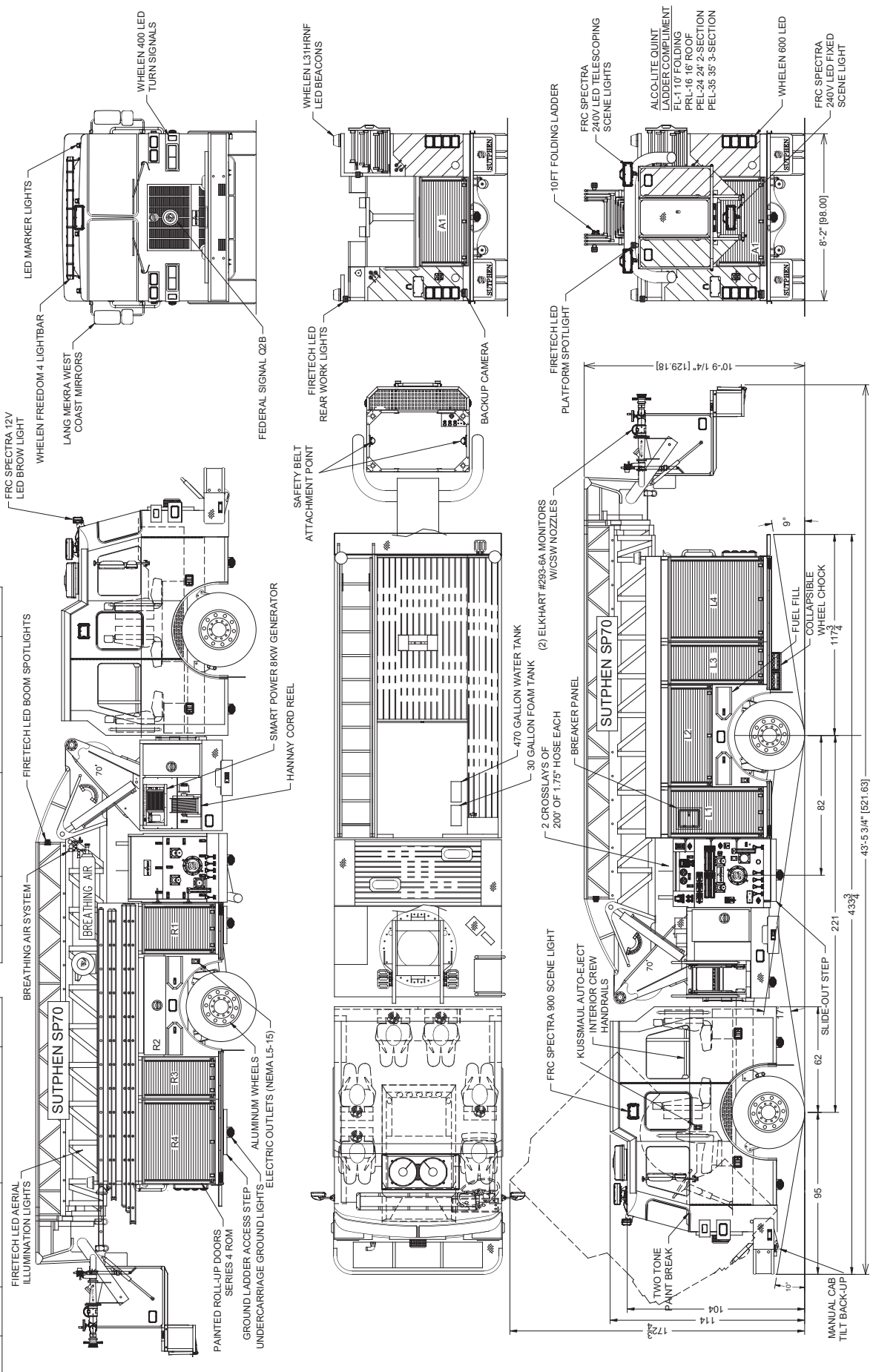

CUSTOMER APPROVAL

NAME: _____ DATE: _____

TITLE: _____

DESCRIPTION: _____

REV. _____ BY _____ DATE _____

THIS PRINT IS PROVIDED ON A RESTRICTED BASIS AND IS NOT TO BE USED IN ANY WAY DETRIMENTAL TO THE INTEREST OF SUTPHEN CORPORATION.

SUTPHEN
SUTPHEN
DEMO 452
SP70
HS-6538

DRAWN BY: CAM
DATE: 07/23/2018
MFG. FACILITY: HILLIARD
BY: _____ DATE: _____

DIMENSIONS SHOWN ON THIS DRAWING ARE APPROXIMATE AND ARE SUBJECT TO MINOR DEVIATIONS DURING CONSTRUCTION.
IN THE EVENT OF A DISCREPANCY BETWEEN THE SUTPHEN SPECIFICATIONS AND DRAWING, THE SUTPHEN SPECIFICATIONS SHALL PREVAIL.
DRAWING IS FOR REFERENCE ONLY. SOME ITEMS PROPOSED MAY NOT BE SHOWN OR NOTED.