

COMP.	DOORS	OPENING DIMENSIONS	INSIDE DIMENSIONS	VOLUME
L1	ROLL-UP	37.5" W X 57.4" H	43.1" W X 66" H X 27.3" D	40.8 CU. FT.
	ROLL-UP	57.5" W X 28.2" H	61.6" W X 36.8" H X 27.3" D	29.8 CU. FT.
	ROLL-UP	50.5" W X 57.4" H	58.4" W X 66" H X 27.3" D	50.5 CU. FT.
	LIFT-UP	19" W X 55.6" H	16.1" W X 25.6" H X 21.8" D	52.2 CU. FT.
R1	ROLL-UP	37.5" W X 57.4" H	43.1" W X 66" H X 27.3" D	33.9 CU. FT.
	ROLL-UP	57.5" W X 28.2" H	61.6" W X 36.8" H X 16.0" D	19.0 CU. FT.
	ROLL-UP	50.5" W X 57.4" H	58.4" W X 66" H X 27.3" D	41.9 CU. FT.
	LIFT-UP	19" W X 55.6" H	16.1" W X 25.6" H X 21.8" D	52.2 CU. FT.
* R1 & R3 HAVE 61.6" W X 24.5" H X 16.0" D MIDDLE SECTIONS				
REAR STEP COMPARTMENT				
COMP.	DOORS	OPENING DIMENSIONS	INSIDE DIMENSIONS	VOLUME
A1	ROLL-UP	37.5" W X 32.8" H	40" W X 46" H X 31" D	29.7 CU. FT.
TOTAL: 349.0 CU. FT.				

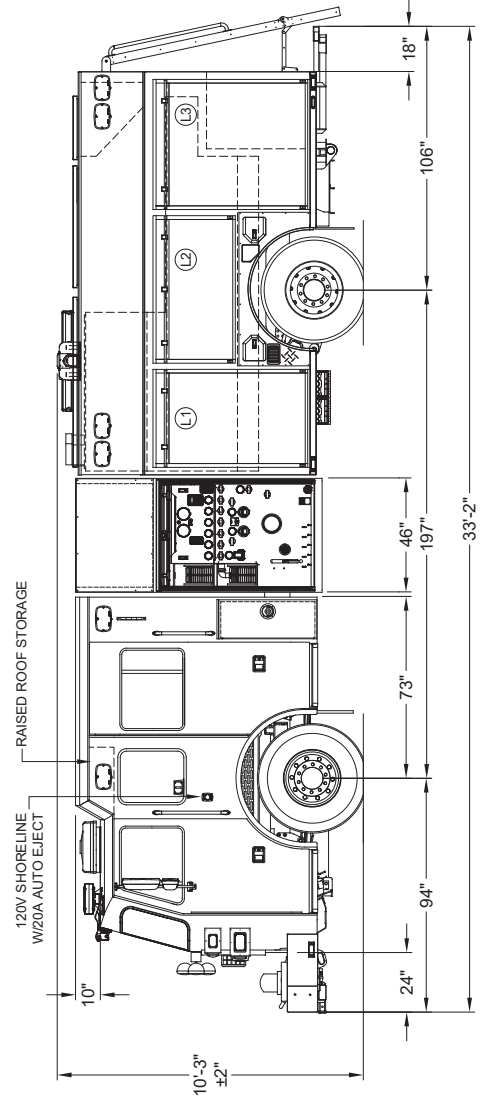
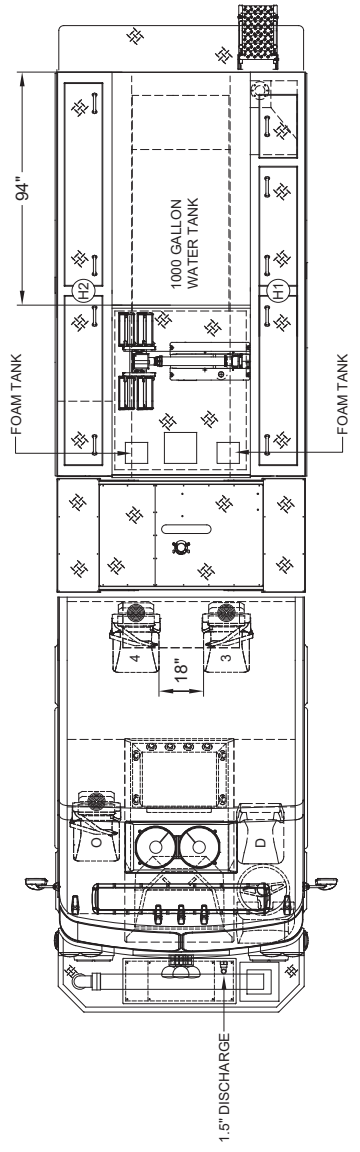
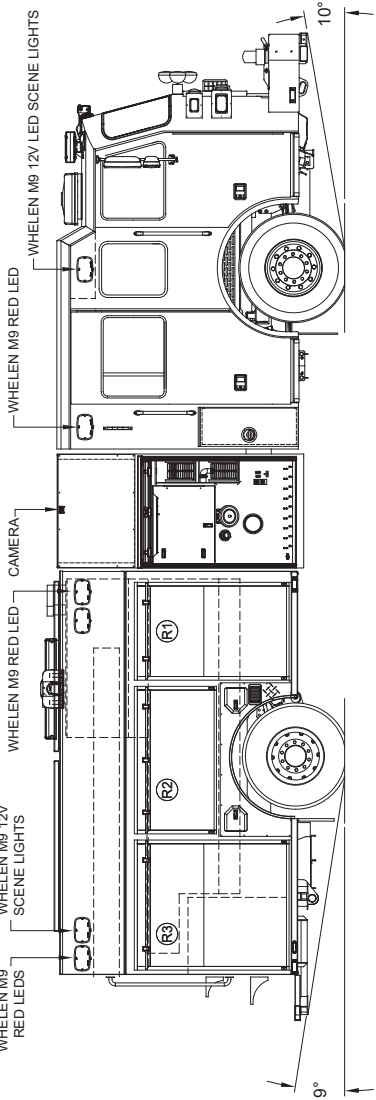
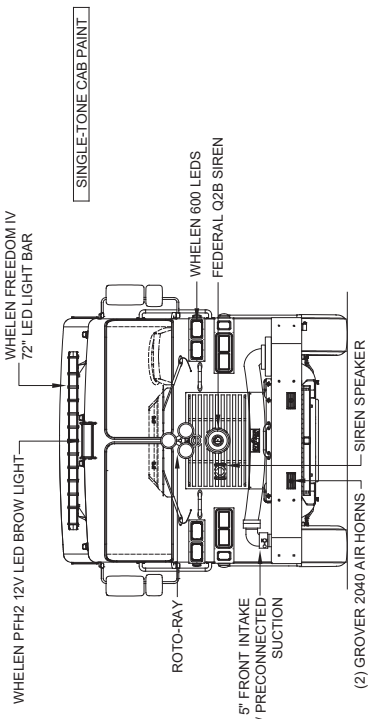

SUTPHEN
ASHLAND FIRE DEPARTMENT
ASHLAND, OH
PRODUCT TYPE - S8 BODY
DWS. NO.

REV. H REV-H SHOP ORDER - (ADDED CHANGES PER FINAL INSPECTION) KMG 10/03/20
 G REV-G SHOP ORDER - MOVED EMS CABINETS TO DEALER SUPPLIED / ADDED NOTES FOR PUMP CAMERA MONITOR MOUNTING. KMG 09/03/20
 F REV-F SHOP ORDER - CHANGED RIGHT REAR ACTUATOR TO PUSH/PULL. KMG 07/27/20
 E REV-E SHOP ORDER - CLARIFIED 18" OF SPACE BETWEEN CREW SEAT 3 AND CREW SEAT 4 ON REAR WALL OF CAB. RM 07/13/20
 DESCRIPTION BY DATE

THIS PRINT IS PROVIDED ON A RESTRICTED BASIS AND IS NOT TO BE USED IN ANY WAY DETRIMENTAL TO THE INTEREST OF SUTPHEN CORPORATION.

DATE: _____

TITLE: _____

NAME: _____

CUSTOMER APPROVAL

DIMENSIONS SHOWN ON THIS DRAWING ARE APPROXIMATE AND ARE SUBJECT TO MINOR DEVIATIONS DURING CONSTRUCTION.

IN THE EVENT OF A DISCREPANCY BETWEEN THE SUTPHEN SPECIFICATIONS AND DRAWING, THE SUTPHEN SPECIFICATIONS SHALL PREVAIL.

DRAWING IS FOR REFERENCE ONLY. SOME ITEMS PROPOSED MAY NOT BE SHOWN OR NOTED.



DRAWN BY: K.GOON
 DATE: 10/17/19
 MFG. FACILITY: DUBLIN
 DATE: 07/13/20

KMG 10/03/20
 KMG 09/03/20
 KMG 07/27/20
 RM 07/13/20

REV. H
 G
 F
 E

REV-H SHOP ORDER - (ADDED CHANGES PER FINAL INSPECTION)
 REV-G SHOP ORDER - MOVED EMS CABINETS TO DEALER SUPPLIED / ADDED NOTES FOR PUMP CAMERA MONITOR MOUNTING.
 REV-F SHOP ORDER - CHANGED RIGHT REAR ACTUATOR TO PUSH/PULL.
 REV-E SHOP ORDER - CLARIFIED 18" OF SPACE BETWEEN CREW SEAT 3 AND CREW SEAT 4 ON REAR WALL OF CAB.

DESCRIPTION BY DATE

THIS PRINT IS PROVIDED ON A RESTRICTED BASIS AND IS NOT TO BE USED IN ANY WAY DETRIMENTAL TO THE INTEREST OF SUTPHEN CORPORATION.

DATE: _____

TITLE: _____

NAME: _____

CUSTOMER APPROVAL

DIMENSIONS SHOWN ON THIS DRAWING ARE APPROXIMATE AND ARE SUBJECT TO MINOR DEVIATIONS DURING CONSTRUCTION.

IN THE EVENT OF A DISCREPANCY BETWEEN THE SUTPHEN SPECIFICATIONS AND DRAWING, THE SUTPHEN SPECIFICATIONS SHALL PREVAIL.

DRAWING IS FOR REFERENCE ONLY. SOME ITEMS PROPOSED MAY NOT BE SHOWN OR NOTED.