

- LADDER CHUTE
- 35' 3-SECTION
- 14' ROOF LADDER
- 10' FOLDING LADDER
- PIKE POLE TUBE
- (1) NY ROOF HOOK TUBE

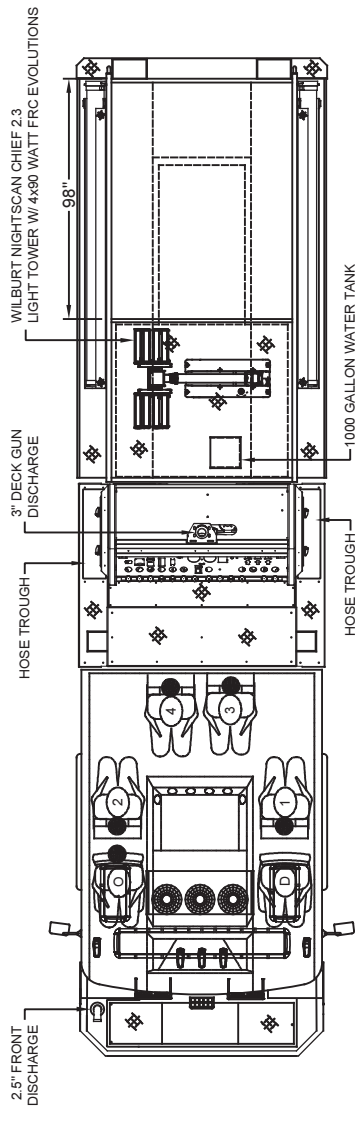

COMPT	DOORS	OPENING DIMENSIONS	INSIDE DIMENSIONS	VOLUME
L1	ROLL-UP	34.5"W X 56.875"H	43.125"W X 66"H X 27.375"D	40.8 CU. FT.
	ROLL-UP	59.5"W X 28.25"H	62"W X 35.375"H X 27.375"D	28.8 CU. FT.
	ROLL-UP	47.875"W X 36.875"H	53.375"W X 66"H X 27.375"D	30.6 CU. FT.
R1	ROLL-UP	34.5"W X 56.875"H	43.125"W X 66"H X 27.375"D (10.5" upper)	31.1 CU. FT.
	ROLL-UP	59.5"W X 28.25"H	62"W X 35.375"H X 10.5"D	13.3 CU. FT.
	ROLL-UP	47.875"W X 36.875"H	53.375"W X 66"H X 27.375"D (10.5" upper)	38.5 CU. FT.
REAR STEP COMPARTMENT				
COMPT	DOORS	OPENING DIMENSIONS	INSIDE DIMENSIONS	VOLUME
A1	ROLL-UP	37.875"W X 30.875"H	40.375"W X 40"H X 27.1875"D	25.4 CU. FT.
TOTAL: 228.3 CU.FT.				

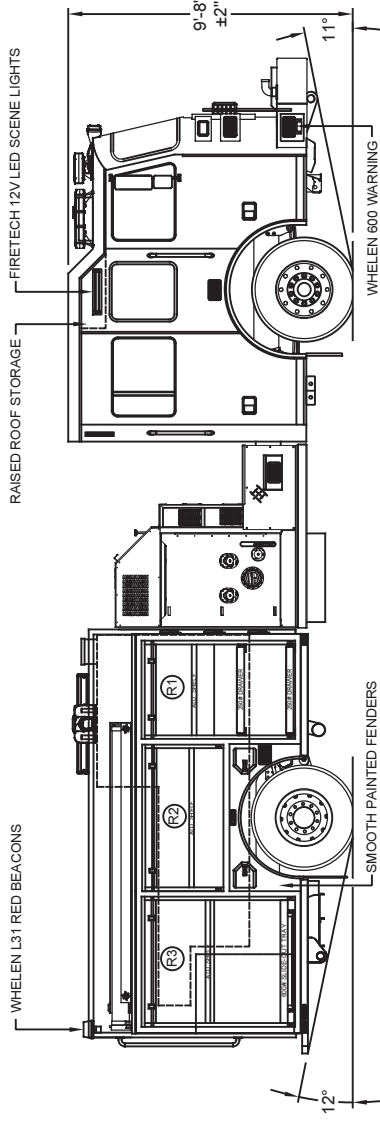
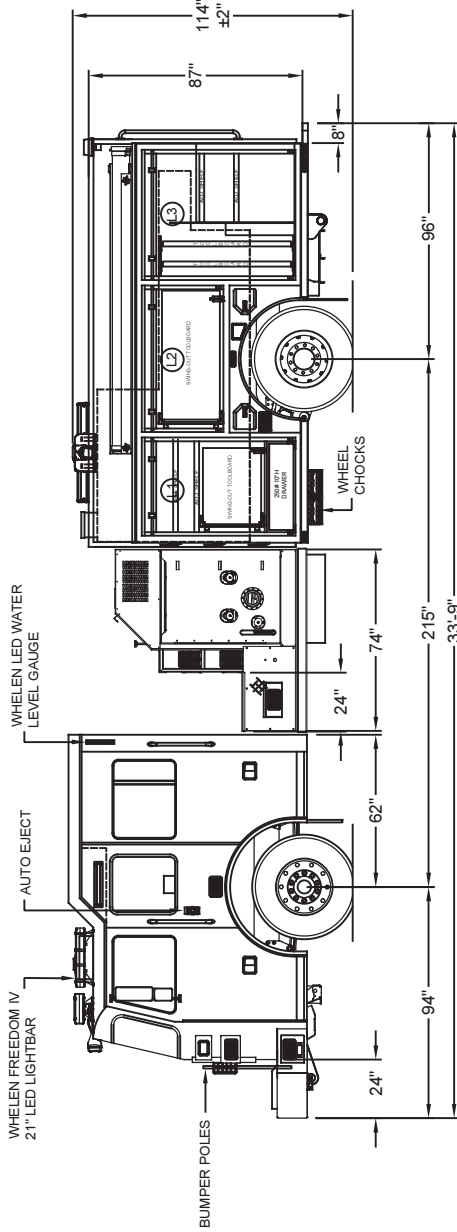
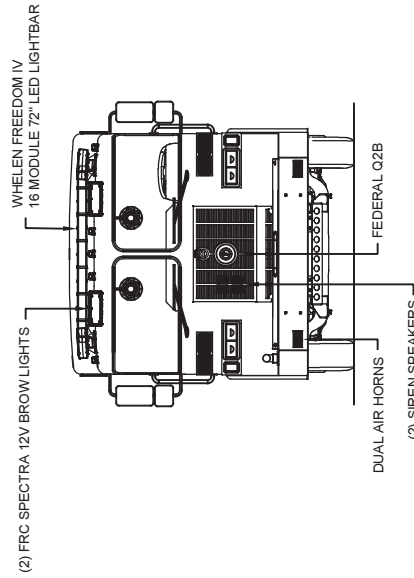

DIMENSIONS SHOWN ON THIS DRAWING ARE APPROXIMATE AND ARE SUBJECT TO VARIATIONS DURING CONSTRUCTION.
IN THE EVENT OF A DISCREPANCY BETWEEN THE DIMENSIONS SHOWN ON THIS DRAWING AND THE SUTPHEN SPECIFICATIONS SHALL PREVAIL.
DRAWING IS FOR REFERENCE ONLY. SOME ITEMS PROPOSED MAY NOT BE SHOWN OR NOTED.

CUSTOMER APPROVAL

NAME: _____
TITLE: _____
DATE: _____

B WARNING LIGHT CALL-OUTS
A REVA SHOP ORDER
REV. _____

DESCRIPTION
BY DATE

DATE 08/31/18
DATE 03/02/18
DATE 03/28/18

DRAWN BY J. MORGAN
MFG FACILITY DUBLIN

BELTING VOLUNTEER FIRE DEPARTMENT
BELINGTON, WV
CUSTOM PUMPER - S2 BODY
JOB NO. HS-0213

