

HOSE LOAD
 200' OF 1.75"
 1000' OF 4"
 500' OF 2.5"
 W/150' OF 1.75"
 200' OF 2.5"

LADDER CHUTE
 (1) 24" SEC
 (1) 14' ROOF
 (1) 10' FOLDING
 (1) BACKBOARD
 (3) PIKE POLE TUBES

COMP	DOORS	OPENING DIMENSIONS	INSIDE DIMENSIONS	VOLUME
L1	ROLL-UP	37.5"W X 56.4"H	43.1"W X 66"H X 27.3"D	37.4 CU. FT. (18"H X 10.5"D UPPER)
L2	ROLL-UP	57.5"W X 26.2"H	61.6"W X 36.8"H X 27.3"D	25.1 CU. FT. (18"H X 10.5"D UPPER)
L3	ROLL-UP	50.5"W X 56.4"H	58.4"W X 66"H X 27.3"D	46.4 CU. FT. (18"H X 10.5"D UPPER)

COMP	DOORS	OPENING DIMENSIONS	INSIDE DIMENSIONS	VOLUME
R1	ROLL-UP	37.5"W X 56.4"H	43.1"W X 66"H X 27.3"D	31.1 CU. FT. (33"H X 10.5"D UPPER)
R2	ROLL-UP	57.5"W X 26.2"H	61.6"W X 36.8"H X 10.5"D	13.8 CU. FT.
R3	ROLL-UP	50.5"W X 56.4"H	58.4"W X 66"H X 27.3"D	38.6 CU. FT. (33"H X 10.5"D UPPER)

COMP	DOORS	OPENING DIMENSIONS	INSIDE DIMENSIONS	VOLUME
AT	DOUBLE	37.0"W X 36.1"H	40"W X 40"H X 31"D	28.7 CU. FT.
				TOTAL: 293.5 CU. FT.

FIRETECH 3-PIECE 72" LED BROW LIGHT
 W/GTT OPTICOM

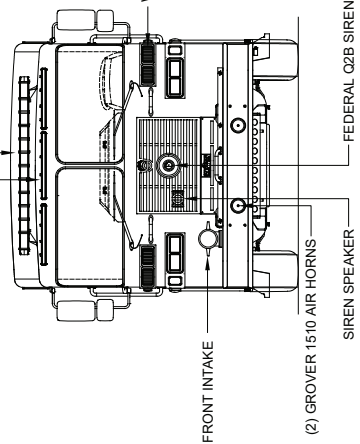

TWO-TONE CAB
 PAINT BREAK OPTION #1
 WHITE OVER RED

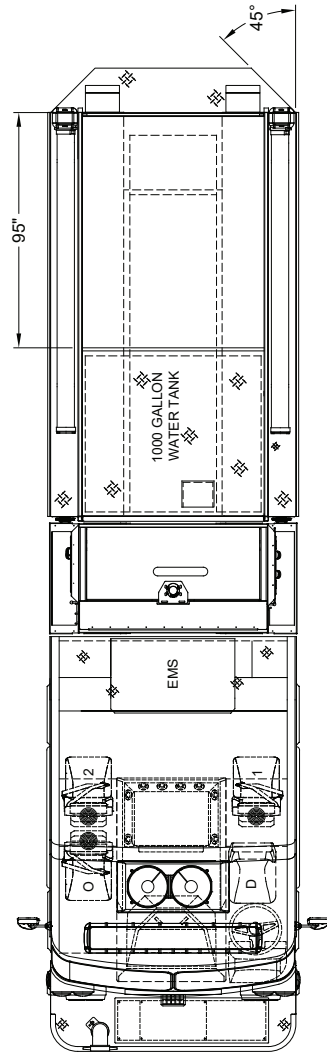
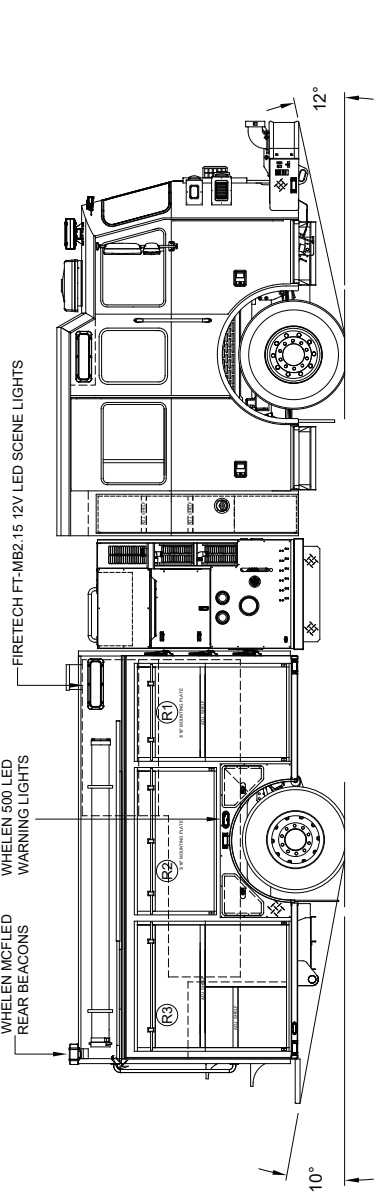

REAR RAISED ROOF STORAGE
 (2) 6"x10" SECTIONS OF HARD SUCTION HOSE

120V SHORELINE W/20A AUTO EJECT

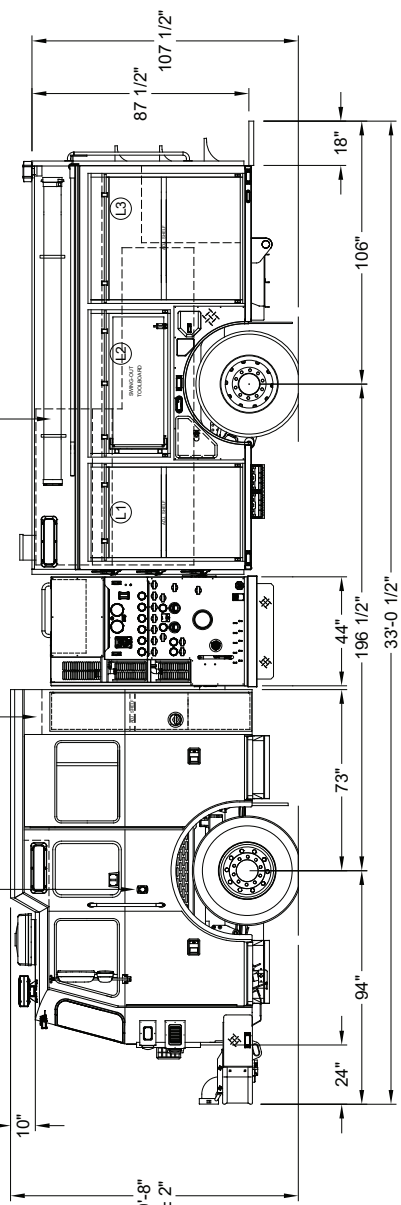

DIMENSIONS SHOWN ON THIS DRAWING ARE APPROXIMATE AND ARE SUBJECT TO MINOR DEVIATIONS DURING CONSTRUCTION.
 IN THE EVENT OF A DISCREPANCY BETWEEN THE SUTPHEN SPECIFICATIONS AND DRAWING, THE SUTPHEN SPECIFICATIONS SHALL PREVAIL.
 DRAWING IS FOR REFERENCE ONLY. SOME ITEMS PROPOSED MAY NOT BE SHOWN OR NOTED.

CUSTOMER APPROVAL
 NAME: _____
 TITLE: _____
 DATE: _____

REV.	DESCRIPTION	DATE	BY
J	CHANGES FROM MID-INSPECTION	03/22/22	KMG
I	MINOR CORRECTIONS TO THE SHOP ORDER DRAWING	03/21/22	KMG
H	REVISED THE CLAR NOTES FOR THE ADDITIONAL 3-WAY SWITCHES FOR THE REAR SCENE LIGHTS	01/06/22	KMG
G	REVISED THE CLAR NOTES FOR THE PUMP PANEL COLOR CODING	12/07/21	KMG